

- NOTES:
1. CONDUCTORS AND CONDUIT SIZED PER WIRING AND CONDUIT SCHEDULE.
 2. COORDINATE FINAL LOCATION, QUANTITIES OF CONDUIT WITH BATTERY MANUFACTURER AND SITE FACILITIES SUPERVISOR.
 3. VERIFY CONDUIT LOCATIONS ARE CLEAR OF ALL EXISTING UTILITIES.
 4. REFER TO BATTERY MANUFACTURER DRAWINGS AND INSTALLATION MANUALS FOR ADDITIONAL DETAILS. ANY DEVIATIONS FROM MANUFACTURER GUIDELINES AND DESIGN SPECIFICATIONS MUST BE APPROVED PRIOR TO INSTALLATION.
 5. MEDIUM VOLTAGE CABLE FROM PV ARRAY NOT SHOWN FOR CLARITY.
 6. REFER TO CIVIL DRAWINGS FOR BATTERY PAD DETAIL.
 7. REFERENCE TESLA POWERPACK INVERTER MANUAL FOR CONDUIT STUB-UP WINDOW LOCATIONS. DO NOT ALTER OR CREATE NEW OPENINGS IN INVERTER OR BATTERY ENCLOSURES.

BATTERY POWER TABLE							
BATTERY				BATTERY INVERTER			
TYPE	SIZE (KWH)	QTY	KWH AC	TYPE	SIZE (KW)	QTY	KW AC
TESLA POWERPACK UNIT	223	8	1,784	TESLA POWERPACK	446	2	892
		8	1,784			2	892

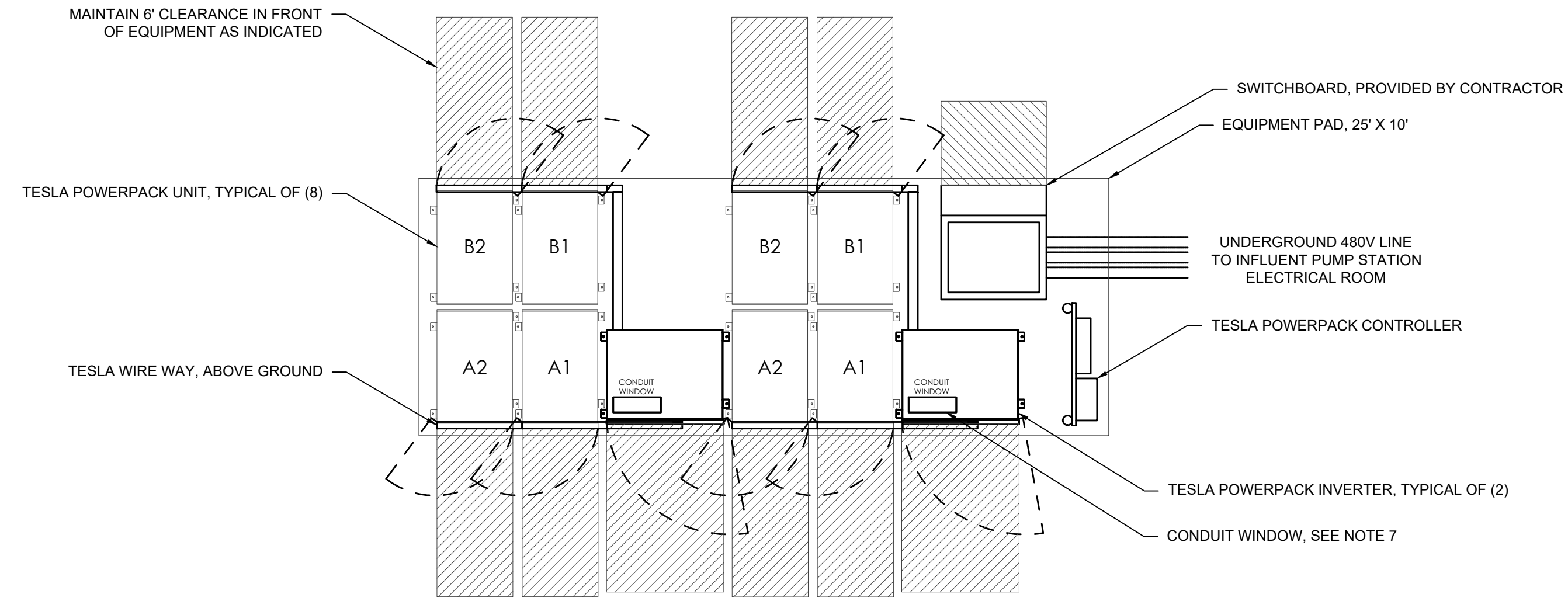

DETAIL A - BATTERY ENERGY STORAGE SYSTEM LAYOUT
SCALE: 1/4" = 1'-0"

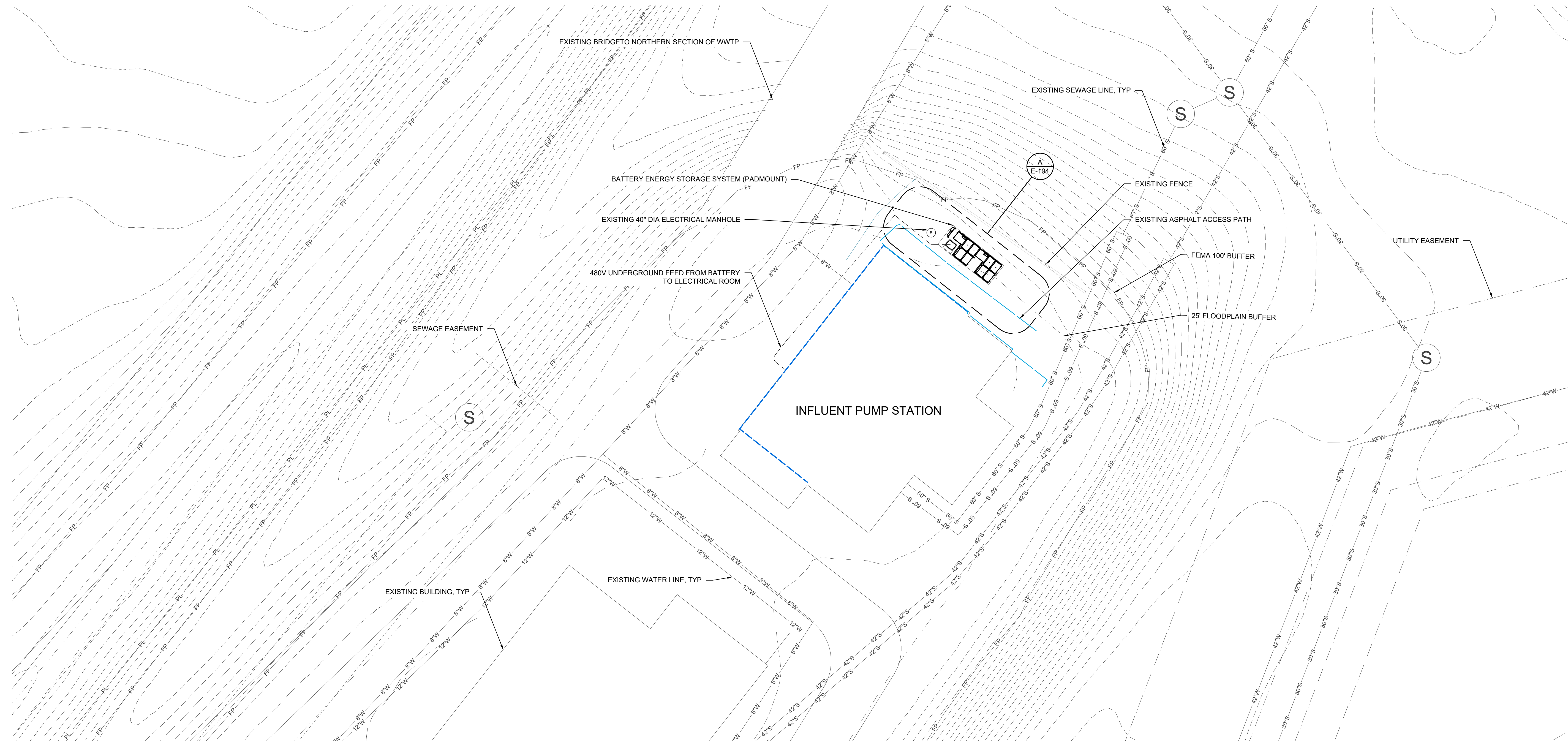

BATTERY ENERGY STORAGE LAYOUT
SCALE: 1" = 20'-0"

ISSUED FOR REVIEW
NOT FOR CONSTRUCTION

SCALE: AS SHOWN
SHEET SIZE: 24" X 36"
DRAWN BY: LB
CHECKED BY: BP
DATE: 11/08/2019
REVISIONS:

NORTHEAST MARYLAND WASTE DISPOSAL AUTHORITY
4520 METROPOLITAN COURT
FREDERICK, MARYLAND 21704
BATTERY ENERGY STORAGE SYSTEM
1,784 KWH (892 KW AC)
BATTERY ENERGY STORAGE LAYOUT

AMERESCO
111 Speen Street, Suite 410
Frammingham, Massachusetts 01701
(608) 661-2200

Copyright 2009 Ameresco. The above drawings, specifications, ideas, designs, and arrangements are and shall remain the property of Ameresco and no part thereof shall be copied, disclosed to others, or used in connection with any work or project other than the project for which they were prepared without the express written consent of Ameresco. Please contact with Ameresco for more information. When dimensions on these drawings shall have precedence over scaled dimensions. Contractors shall verify and be responsible for all dimensions and conditions on the job and this office must be notified of any variations from the dimensions and conditions shown by these drawings.

E-104